

~ Madera Counseling Center ~
 14277 Road 28 / 559-673-3508
 ~ Family Treatment Center ~
 (Healthy Beginnings, Yosemite Women's Center,
 Prevention & AOD Youth Treatment Services)
 14227 Road 28 / 559-675-7920

Heading north from Fresno, take Gateway exit,
 east (right) on Olive, north (left) on Road 28

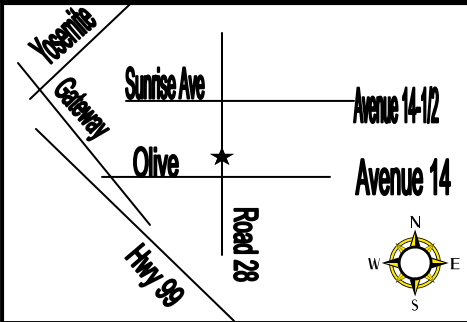

~ Oakhurst Counseling Center ~
 49774 Rd 426, Ste D / 559-683-4809
 Corner of Road 426 & Highview Drive

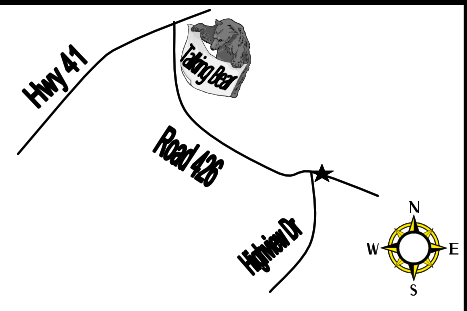

~ Chowchilla Clinic ~
 1200 Ventura Ave / 559-665-2947
 Corner of Ventura & 12th, next to Hospital

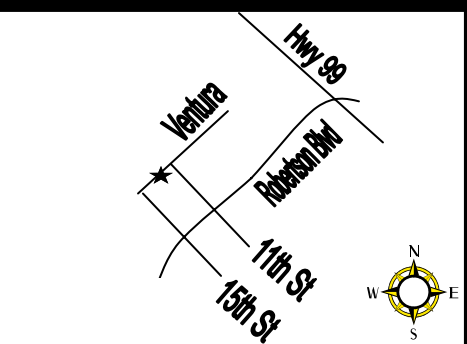

~ Juvenile Justice System ~
 ~ Court Day School ~
 28281A Ave. 14 / 559-675-6560
 Heading north from Fresno, take
 Gateway exit, east (right) on Olive

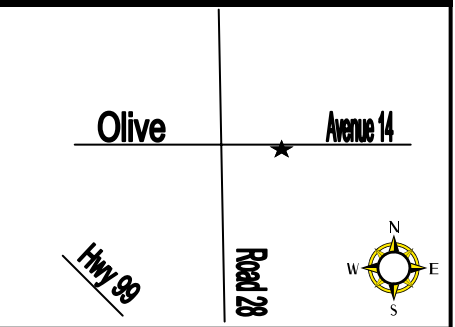

Behavioral Health Services Administration
 117 North R Street / 559-675-7926
 Hope House / 559-664-9021

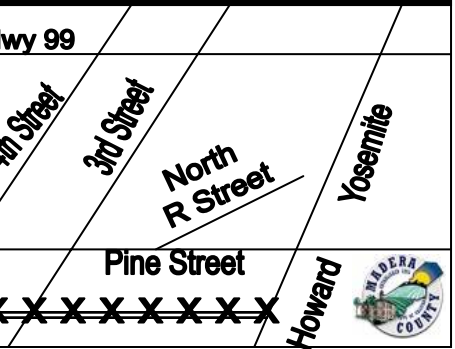

~ Supervision & Treatment
 Program (Prop. 36) ~
 ~ Felony Drug Court ~
 450 Madera Ave Ste H / 559-675-4515

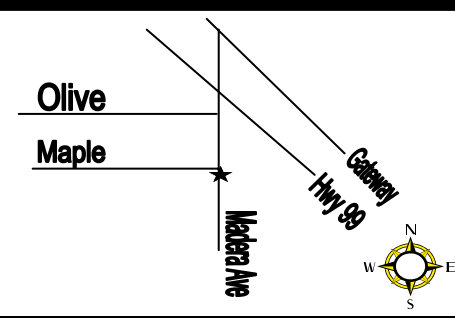

~ Madera Access Point ~
 ~ Adult AOD ~
 424 N. Gateway Dr. / 559-675-7762
 Corner of Gateway & 3rd Streets

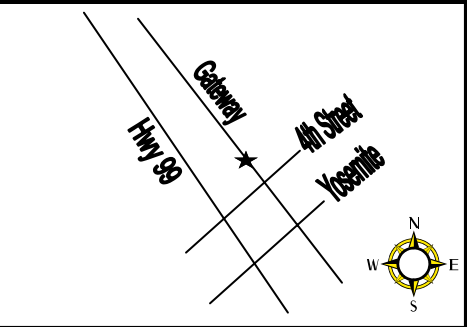

1200 Maple Street/559-661-5194

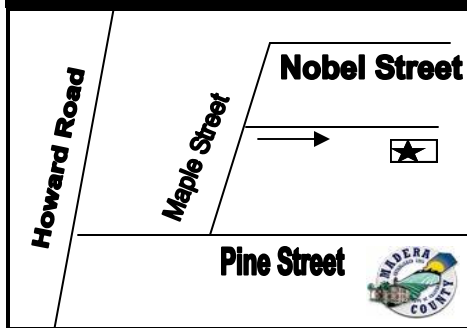

~ Lake Street Center ~
 121 N. Lake Street / 559-661-5156
 First block north of Lake & Yosemite

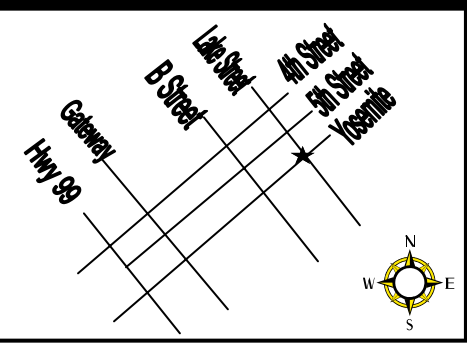

Behavioral Health Services

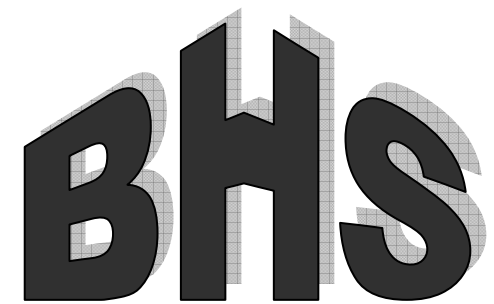

Service Directory

Madera County Behavioral Health Services is a public agency offering alcohol, drug, and mental health recovery and treatment programs.

**Madera County
Behavioral Health Services
(BHS)**

MISSION STATEMENT

To promote the prevention of and recovery from mental illness and substance abuse for the individuals, families, and communities we serve by providing accessible, caring, and culturally competent services.

CORE VALUES

We, the employees of Madera County Behavioral Health Services, value:

- The promotion of wellness and recovery.
- The integrity of individual and organizational actions.
- The dignity, worth, and diversity of all people.
- The importance of human relationships.
- The contribution of each employee.

24-HOUR PHONE LINES

Toll Free 888-275-9779

Emergency Psychiatric Services

559-673-3508

Screening and Referral for Mental Health Services

559-675-7850

Adult Substance Abuse Services

559-675-7762

Youth Substance Abuse Services

559-675-7920

If you speak a different language or have physical limitations, we will help you find available, appropriate, and accessible services.

DIRECTORY OF SERVICES

Web Address: www.madera-county.com

Madera Counseling Center 559-673-3508

14277 Road 28, Madera, CA 93638

Outpatient mental health services for children, adults and families, as well as dual diagnosis and crisis intervention services during office hours.

Oakhurst Counseling Center 559-683-4809

49774 Road 426, Ste. D, Oakhurst, CA 93644

Outpatient mental health, drug and alcohol services for children, adults and families, as well as crisis intervention services.

Chowchilla Clinic 559-665-2947

1200 Ventura Ave., Chowchilla, CA 93610

Outpatient mental health, drug and alcohol services for children, adults and families.

Adult Alcohol and Drug Program

559-675-7762

424 N. Gateway Drive, Madera, CA 93637

Adult outpatient treatment for alcohol and other drugs. Includes individual, family and group counseling. Case management, and outreach services are offered

Felony Drug Court 559-675-4515

450 Madera Ave., Suite H, Madera, CA 93637

Provides substance abuse offender resources and treatment to reduce the negative results of addiction. Individual, group and family counseling to aid rehabilitation and recovery are offered.

Court Day School CDS 559-675-6560

28281A Ave. 14, Madera, CA 93638

A multi-agency collaborative program located on the Enterprise Secondary School Campus. Available services include individual and family counseling, parent education, anger management and case management.

Healthy Beginnings 559-675-7920

14227 Road 28, Madera, CA 93638

A collaborative, interagency program that provides assessment and intensive intervention services to children 0-5 and their families. Service areas include; health, early childhood education (0-3), school readiness (4-5 yr olds), mental health and social services.

Juvenile Justice System 559-675-6560

28281A Ave. 14, Madera, CA 93638

Services to youth referred by Madera County Probation including individual and family counseling, parent education, anger management, and case management.

Lake Street Center 559-661-5156

121 N. Lake Street, Madera, CA 93638

A multi-agency program that provides services for foster children. Mental health counseling, public health services, behavioral case management, social services, and psychiatric services are offered.

Madera Access Point 559-675-7762

424 N. Gateway Drive, Madera, CA 93637

A collaborative program providing counseling, employment development services and additional support/educational groups for CalWORKs participants with identifiable barriers of mental health, substance abuse, and domestic violence issues.

Maple Street Center 559-661-5194

1200 Maple Street Suite 108, Madera, CA 93637

This program serves MHSA Adult and Older Adult Full Service Partnership clientele. The Mentally Ill Offender Crime Reduction (MIOCR) project participants are also served at this location. Both programs serve adults who have been or who are at risk of incarceration.

Supervision and Treatment Program

(Prop. 36) 559-675-4515

450 Madera Ave, Ste. H, Madera, CA 93637

A unique partnership between the courts, legal system, probation, parole, and treatment that provides services for non-violent drug-offenders by offering individual, group counseling, supervision by probation/parole, and case management services.

Yosemite Women's Center 559-675-7920

14227 Road 28, Madera, CA 93638

Outpatient services for women and their families affected by alcohol and/or other drugs. Services include: individual, group, case management, intervention and Perinatal services.

Youth Alcohol & Drug Program 559-675-7920

14227 Road 28, Madera, CA 93638

Youth outpatient treatment for alcohol and other drugs. Includes individual, family and group counseling. Services include prevention, outreach, and case management.

Mental Health Board

Alcohol and Drug Advisory Board

Advisory Boards comprised of members/volunteers from the community who are appointed by the Board of Supervisors and provide support, guidance, and direction to BHS.

Mental Health Services Act (MHSA)

MHSA services are county-wide and include full service partnerships for children, transitional age youth, adults, and older adults; a socialization community drop-in center (Hope House); social supports and services; outreach and engagement; and services for the Unserved and underserved populations.

Hope House 559-664-9021

117 North R Street, Suite 103, Madera, CA 93637

BHS contracts with Turning Point to provide this MHSA funded socialization and drop-in center for adult consumers. County-wide transportation is available to transport consumers to Hope House for participation in classes, support groups, and other activities.

Behavioral Health Services Administration

559-675-7926

117 North R Street, Madera, CA 93637

BHS administrative services (Fiscal, MHSA Prevention & Early Intervention, Housing, Workforce & Training, & Cultural Competency, Mental Health Plan, Quality Assurance) are conducted at this site.